

# PARKING LAYOUT AMHERST TRANSIT PROPERTIES, INC. TRANSIT AND CASEY EAST AMHERST, NEW YORK

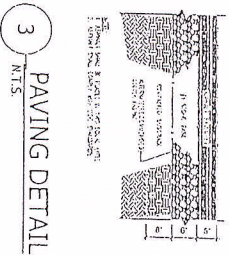

ARCHITECT OF RECORD:  
MARK W TIEDEMANN  
DESIGN STUDIOS AT MWT, P.C.

CONTACT:  
DANIEL P. UEHLER  
PROJECT MANAGER  
716-312-1700 EXT 104  
FAX: 866-611-9633  
EMAIL: duebler@mwtusa.com

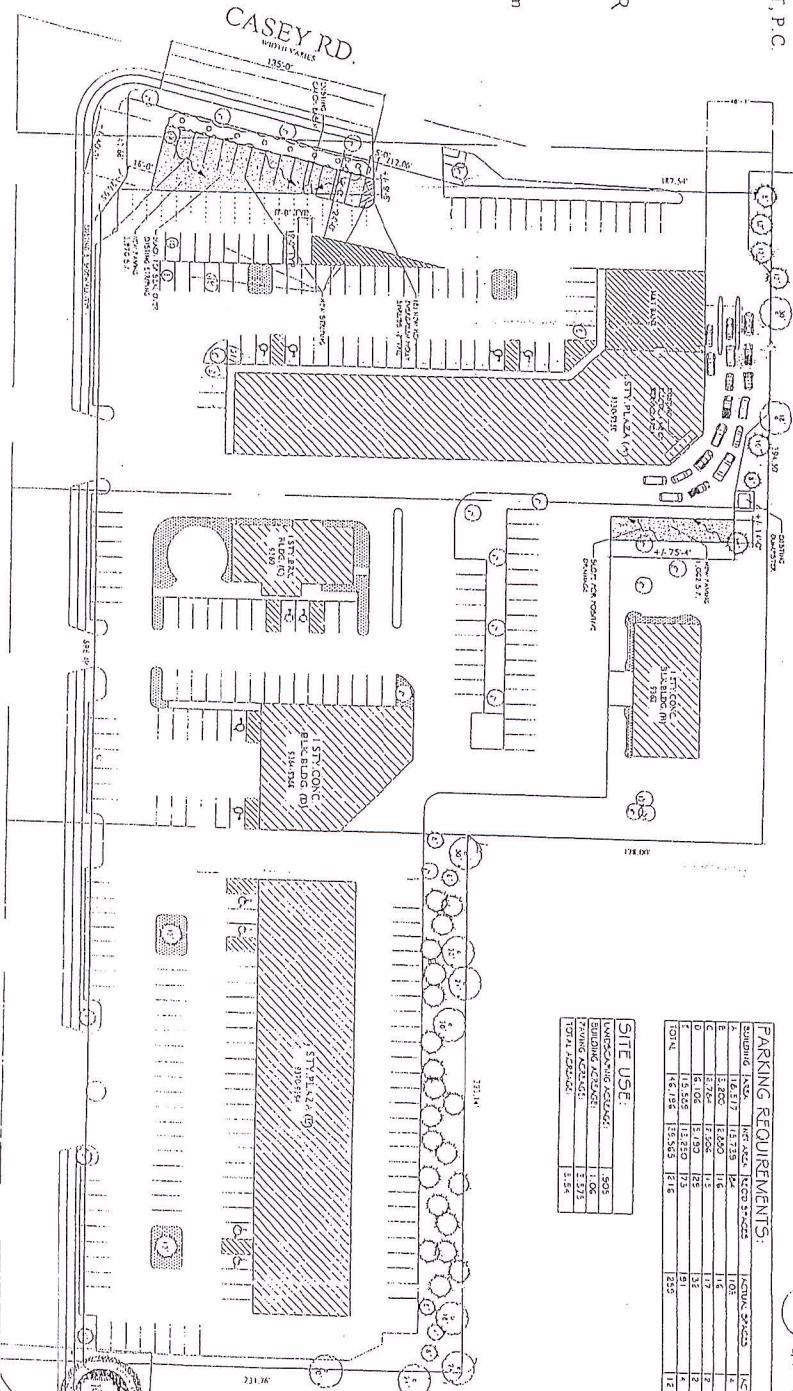

3 PAVING DETAIL  
N.T.S.

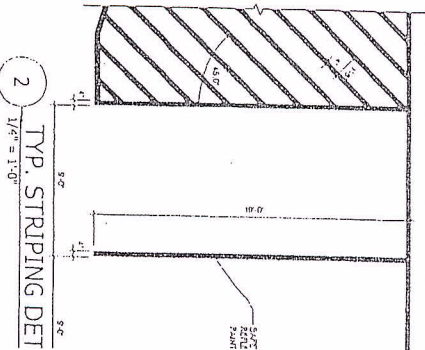

2 TYP. STRIPING DET  
1/4" = 1'-0"

**PARKING REQUIREMENTS:**

BUILDING	AREA	NET AREA	NEED STRIPES	ACTUAL	NO. OF
A	16,817	12,735	1.05	13	4
B	3,202	12,000	1.16	14	2
C	15,106	15,100	1.02	15	2
D	15,106	15,100	1.02	15	2
E	15,528	12,210	0.73	9	4
TOTAL	66,763	57,145	0.86	66	12

**SITE USE:**

UNPAVED AREAS:	505
BUILDING FOOTPRINT:	1,006
TOTAL PAVED:	1,511
TOTAL AREA:	1,511

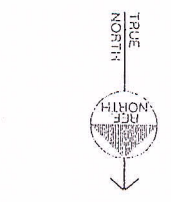

1 SITE PLAN  
1" = 40'-0"

PART OF LOT 101  
T13 S7  
TOWN OF AMHERST  
ERIE COUNTY  
NEW YORK

TRANSIT RD.  
WIDTH VARIES

INFORMATION USED  
TAKEN FROM SURVEY PREPARED  
BY:  
DEBORAH KAYSON A.E. P.C.  
4400 CAMDEN ST  
AMHERST, NY 14303

**EXISTING LANDSCAPING**

SYMBOL	TREE
(Symbol)	DECIDUOUS TREES
(Symbol)	CONIFEROUS TREES
(Symbol)	SHRUBS & BUSHES

TOWN OF A  
APPROVE  
7 MAKE THE PLAN  
SHOW THE PLAN  
CONFORMANCE  
DATE: 08-27-14  
BY: [Signature]